

IS IT THURSDAY YET?

Social Narrative



PAC ■ NYC
PERELMAN PERFORMING
ARTSCENTER

Getting to PAC NYC

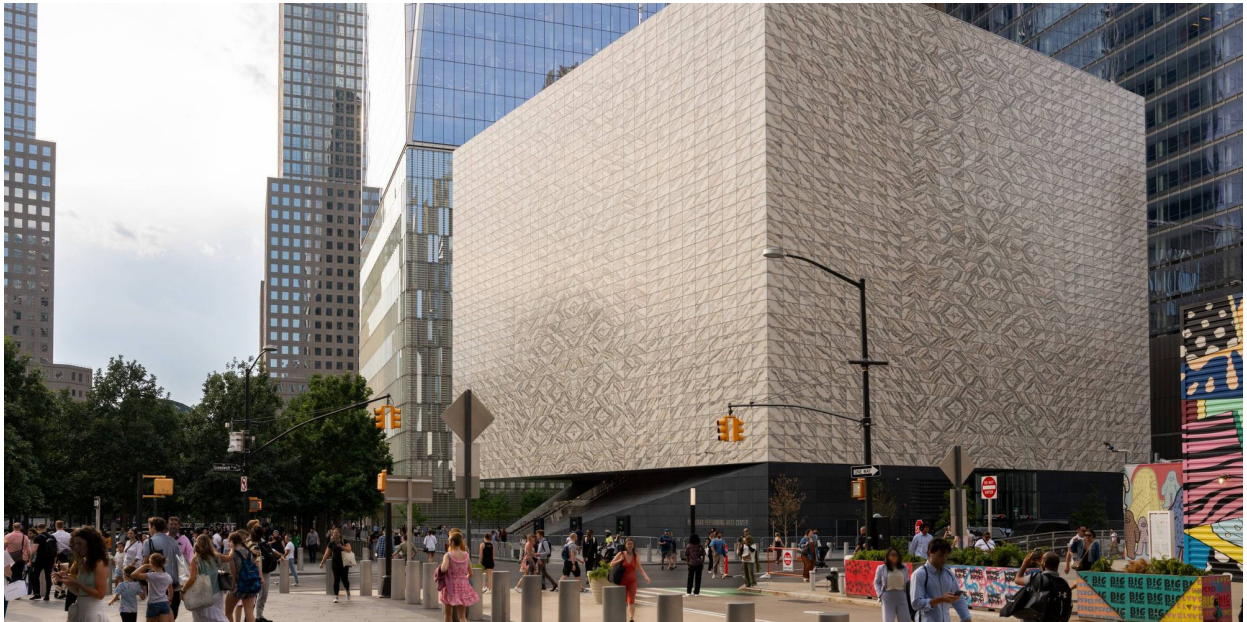

Perelman Performing Arts Center (PAC NYC) is located at 251 Fulton Street at the corner of Greenwich Street. Conveniently located at the transportation hub of the World Trade Center, we are within blocks of 13 subway lines, the PATH train and ferries to New Jersey, and the Staten Island Ferry.

Visit:

<https://pacnyc.org/visit/getting-here/>

For detailed instructions for all modes of transportation including Access-a-Ride.

INFORMATION ABOUT THE SHOW



Is It Thursday Yet? is a stunning tapestry of dance, live music and home video footage that invites you into the unique complexities of dancer and choreographer Jenn Freeman's life following her Autism Spectrum Disorder diagnosis at age 33. Since then, she has navigated an endless sea of epiphanies, examining childhood memories through this new lens.

The performance will take place in the Mike Nichols Theater.
The performance will last approximately 75 minutes.

Visit:

<https://pacnyc.org/whats-on/is-it-thursday-yet/>

For more information and resources regarding the *Is It Thursday Yet?*

ARRIVING AT PAC NYC



When you arrive at 251 Fulton Street you can either take two flights of stairs up to the main entrance, or you can use the elevator located down a short tunnel to the left of the main staircase.

When you enter PAC NYC you will be greeted by a member of our security team who will have you pass through a security scanner. The security team may also ask to look inside any bags you have with you.

Once you have passed through security you can visit the information desk to retrieve tickets or ask any question you may have.

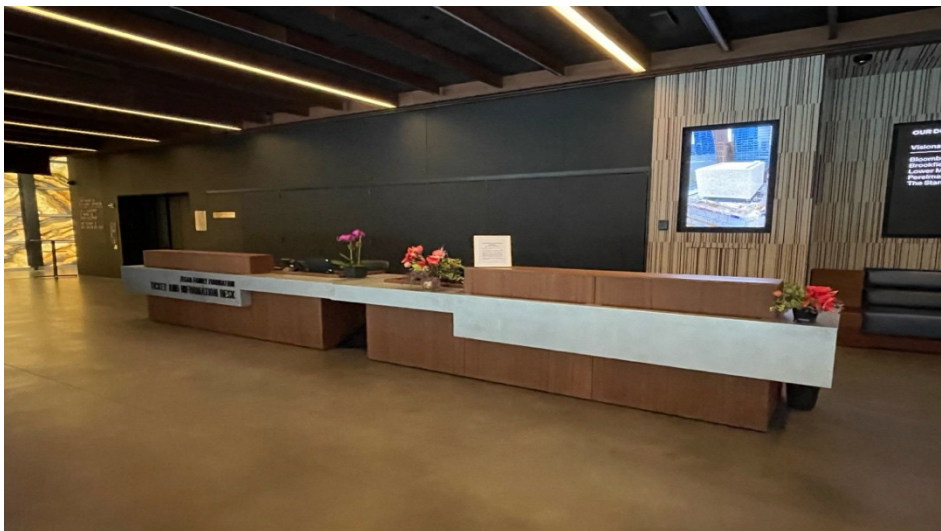

WAITING FOR THE SHOW



The theater will open for audience seating approximately 30 minutes before the performance. There are many areas to sit and wait in our lobby space until you are ready to head into the theatre. There is a quiet area on the south side of the building with private seating, called “The South Bridge.”

There may be a performance happening on our Lobby Stage when you arrive in this space. You can find more information about Lobby Stage performances here:

<https://pacnyc.org/lobby-stage/>



YOUR TICKET

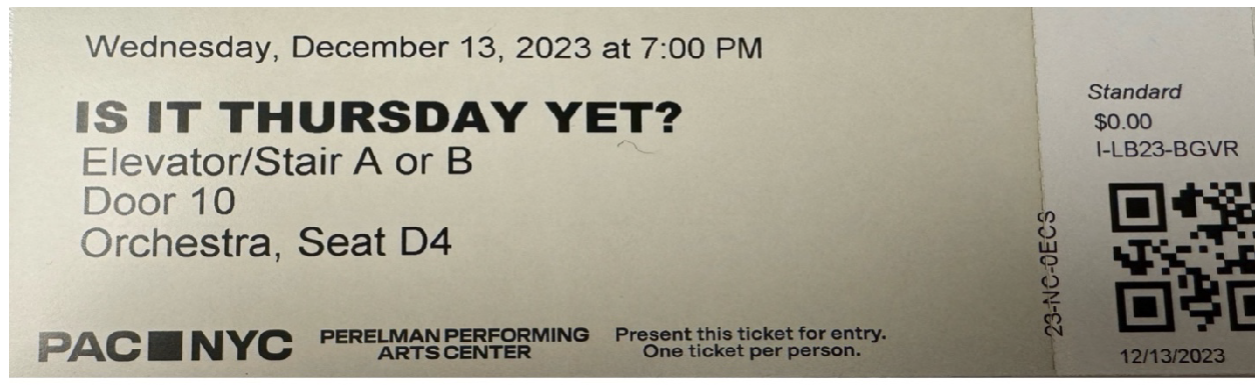

Your ticket will have all the information you need to find the theater and your seat. You can visit the box office for a printed ticket, or you will receive your ticket digitally via email and text message.

Each ticket will list which elevator or staircase you will want to use to get to the 4th floor where the theater is located. *There are no bathrooms on the 4th floor so don't forget to stop by the 3rd floor if you need to use the facilities. *

Your ticket will also tell you which door you will want to use to enter the theater. There are many doors on the 4th floor, and you will want to enter through your listed door to easily get to you seat.

Finally, your ticket will tell you which area, row, and seat number you will be sitting in.

There is a lot of information on your ticket, but don't forget, there will be many representatives from our audience services team to help you find your way.



GETTING TO THE THEATER



When you are ready to head upstairs to Mike Nichols Theater on the 4th floor you can either use the stairs or the elevator. Audience services reps will be available to guide you and answer any questions you may have.

Restrooms are located on the second floor in the lobby through the restaurant, or on the 3rd floor just off the elevator and stairs.

Please note that there are no restrooms on the 4th floor.



GETTING TO YOUR SEAT



When you arrive at the 4th floor you will enter the theater through Door 8 or Door 10. An audience service member will greet you and guide you to your assigned seat.

You will be provided with a program for the show and a sensory bag with additional information on the show and sensory tools.

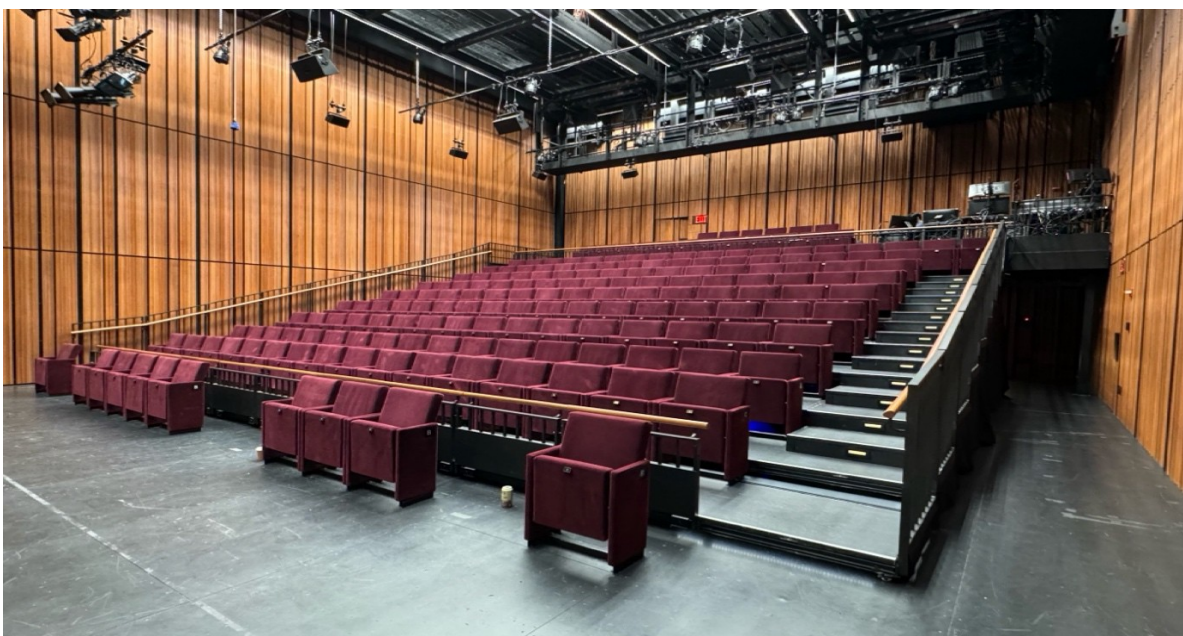

WHAT YOU CAN EXPECT



To see

3 live performers, a stage with an array of set pieces that will be moved around, projections, home video footage, and dancing.



To hear

Live musical instruments including: voices, clarinets, drums, loop machine, and an array of other sounds that range in volume from very quiet to very loud.

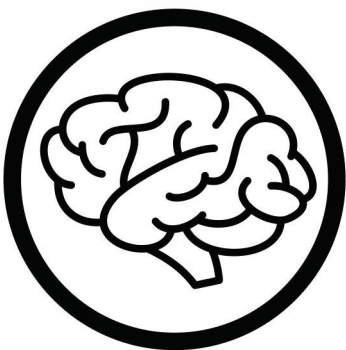

To experience

You will be lead through Jenn's experience of receiving a diagnosis of ASD later in life. You will witness subject matter that includes ASD, OCD, environmental sensory sensitivities and physical stimming, nostalgia, memory, play and discovery, as well as therapy sessions and other diagnostic criteria. This story is expressed through movement, media, and music.

WHO YOU WILL SEE ONSTAGE



Holland Andrews
Composer & Musician



Price McGuffey
Percussionist



Jenn Freeman
Performer & Creator

WHAT YOU WILL SEE ONSTAGE



Boxes holding the contents of a childhood, a screen for projection, two platforms that will house our musicians, and clouds in the sky.

SENSORY ADVISORIES

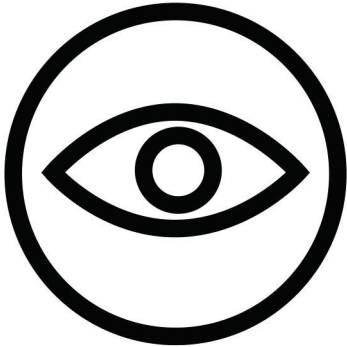

This show includes loud sounds; vocal distortion; horns, drums, and vocal music; and repetition.
Additional context to be provided.



This show includes bright lights, flashing lights, moments of darkness, and lighting of varying intensity. It also includes multiple television monitors displaying images that may be warped or variable in size and scale. Additional context to be provided.

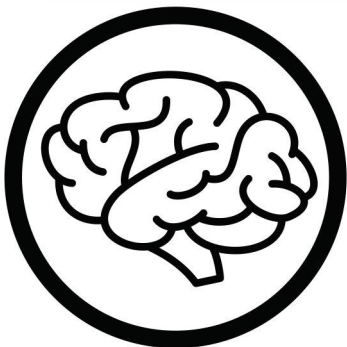

This show includes recorded audio and video from clinical therapy sessions that include discussions of Jenn Freeman's autism spectrum disorder (ASD) and diagnostic terminology.

AFTER THE SHOW



When the show is over you can leave any items you would not like to take with you at your seat, or hand them to an audience services rep. You will exit the theatre through the door you came in. You can use the elevator or stairs to return to the lobby. If you need to use the restroom, stop at the 3rd floor or the lobby before you leave.

Thanks for visiting us at PAC NYC!

PAC ■ NYC
PERELMAN PERFORMING
ARTS CENTER